

IN-LINE FANS

TDM Series

The TDM series of axial fans have been specifically designed to be installed in **low pressure ducted systems**. Single phase motor 230V-50Hz, Class II, IPX4.

Protected against overheating. Suitable to operate within temperatures up to 40°C.



Model TDM-100



TDM-300 Model

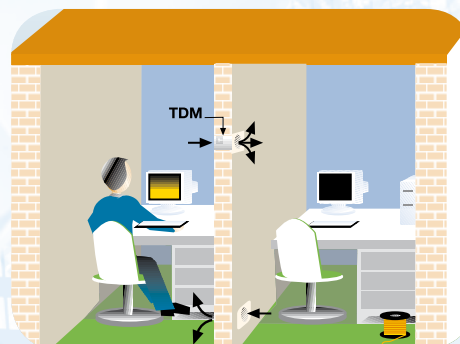
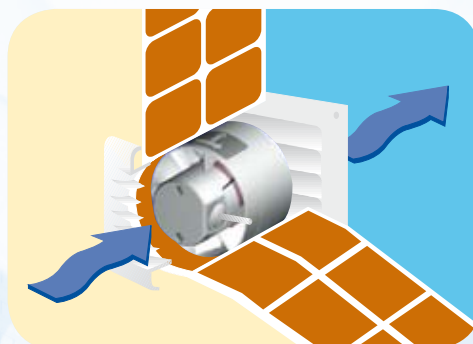

Models 100 and 200 can be installed within a wall to provide exhaust air operation or to exchange heat between adjacent rooms

■ Technical characteristics

Model	Speed (r.p.m.)	Maximum absorbed power (W)	Ø duct (mm)	Air volume at free discharge (m ³ /h)	Sound pressure level * (dB(A))	Weight (kg)
TDM-100	2500	13	100	110	40	0,4
TDM-200	2600	25	125	200	44,5	0,6
TDM-300	2200	35	150	300	45	1,5

* Sound pressure level measured at 1,5 m, at the inlet side, in free field.

■ Dimensions (mm)

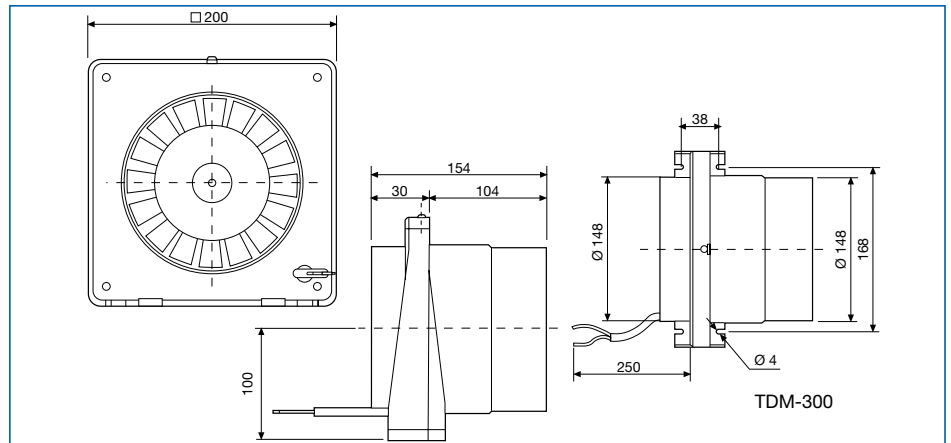
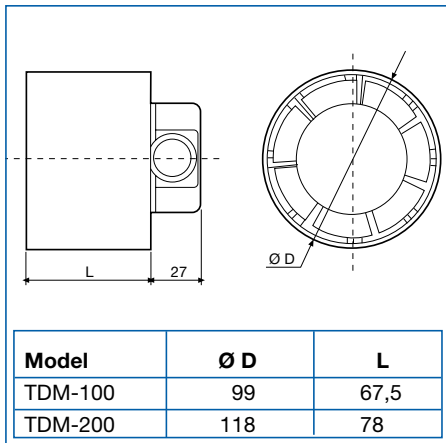

■ Performance curves

- Q = Air volume in, m³/hr and m³/s.
- Ps = Static pressure in Pa.
- Dry air at 20°C and 760 mmHg.
- Performance data in accordance with ISO 5801 and AMCA 210-99 Standards.

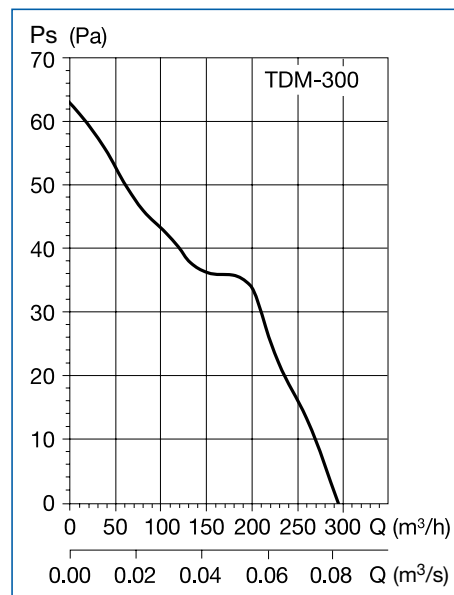
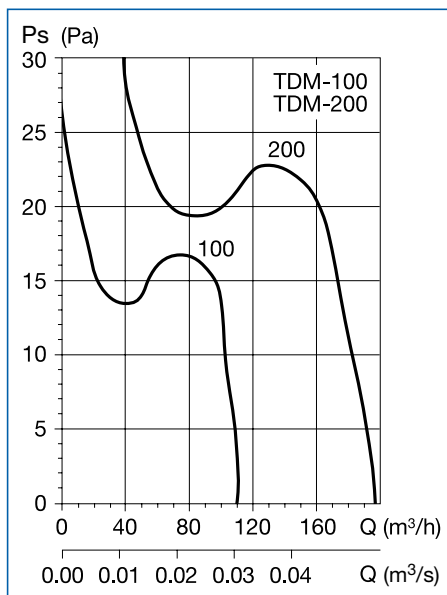

■ Accessories



GSA
Flexible aluminium ducting



GR-100
GRA
Exterior aluminium discharge guard



CX
Worm drive clips



PER-W
Plastic back draft shutters

Accessories	Discharge guard	Back draft shutters	Worm drive duct clamps	Aluminium flexible ducting
TDM-100	GR-100	PER-100W	CX-80/125	GSA-100
TDM-200	GRA-100	PER-125W	CX-125/215	GSA-125
TDM-300	GRA-150	PER-160W	CX-125/215	GSA-150